

ASEPT



Asept Countertop Dispenser

User Manual

DISPENSER PARTS

7231 Check valve

9018 Nozzle

9590 Cleaning brush

8454 Knob

9020 Lid

9015 Pump mechanism

9012 Pump housing

9013 Inlet valve

9016 Table mount

9021 Dispenser housing

9017 Locking nut

9009 Quick
connector

9019 Tube

9472 Connector 16 mm/
8031 Connector BiB

1



1. Mounting the Nozzle

Push the Upper Check valve (7231) onto the upper inlet of the Pump housing (9012) so it aligns with the widening of the inlet and push thereafter the Nozzle (9018) over it.

2

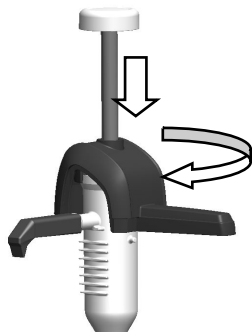

2. Attaching the Pump mechanism

When assembling the pump for the first time slide the Pump mechanism (9015) through the hole in the Lid (9020) and then press the Knob (8454) onto the Pump mechanism until it snaps in place. Attach the Pump mechanism by lowering it down in the pump housing and then locking it by pushing down and turning the lid clockwise.

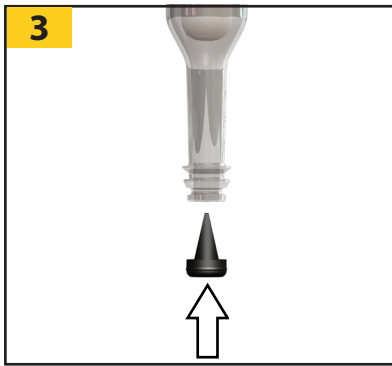

3. Attaching the Inlet valve

Push the Inlet valve (9013) into the pump housing until it slips in the grooves.

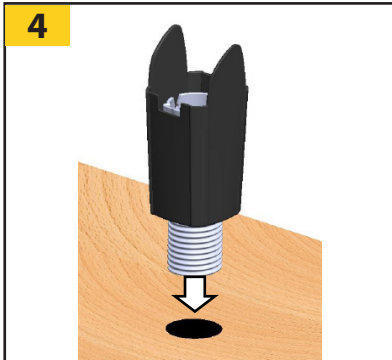

4. Attaching the Dispenser to a Counter

Drill a Ø52mm(2") in the bench. Place the Table mount (9016) inside the Dispenser housing (9021). Place the threaded part in the hole.

The bench thickness has to be max 38mm (1.5")



5. Securing the Dispenser to the Counter

Tighten the Locking nut (9017) until it locks the dispenser to the bench.



6. Inserting Pump

Lower the pump wings into the guides in the Table mount and push until it snaps in place, thereafter place the Lid over the Pump.

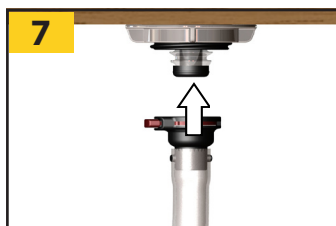

7. Attaching the Tube

Attach the Tube (9019) to the Quick connector (9009). Push the Quick connector on to the Pump housing until it snaps in place.



8a. Connecting to a Pouch

Place a new pouch on a flat surface. Locate the fitment. Place the connector (9472) in the centre of the fitment. Firmly push the connector into the fitment until it snaps in place.



8b. Connecting to a Bag

Place a new bag on a flat surface. Open the lid of the bag and firmly press the connector (8031) into the opening of the bag. For safety's sake, check the connector for a correct and tight fit.

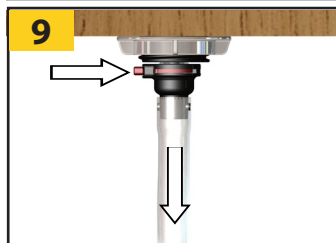

9. Removing the Quick connector

Remove the Quick connector from the underside of the pump by first pressing and holding down the red button and then pulling the the whole connector down.

Cleaning

- Disassemble the pump in opposite order from point 3 "Attaching the inlet valve" to point 1 "mounting the nozzle".
- Rinse off any product residues with warm running water.
- Rinse and clean the inside of the parts with enclosed the Cleaning brush (7615).
- Clean all parts in a dishwasher.
- Remove excessive water before reassembly of the dispenser.

ASEPT